

First Floor Bathroom Window 'W-01-05'

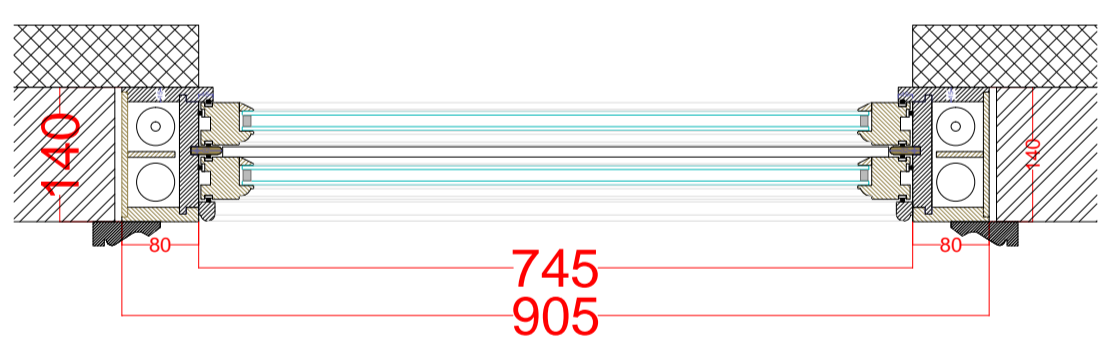
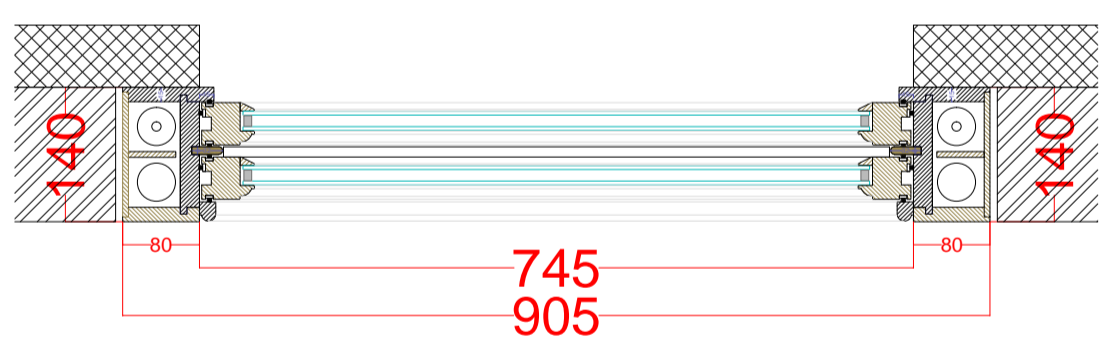
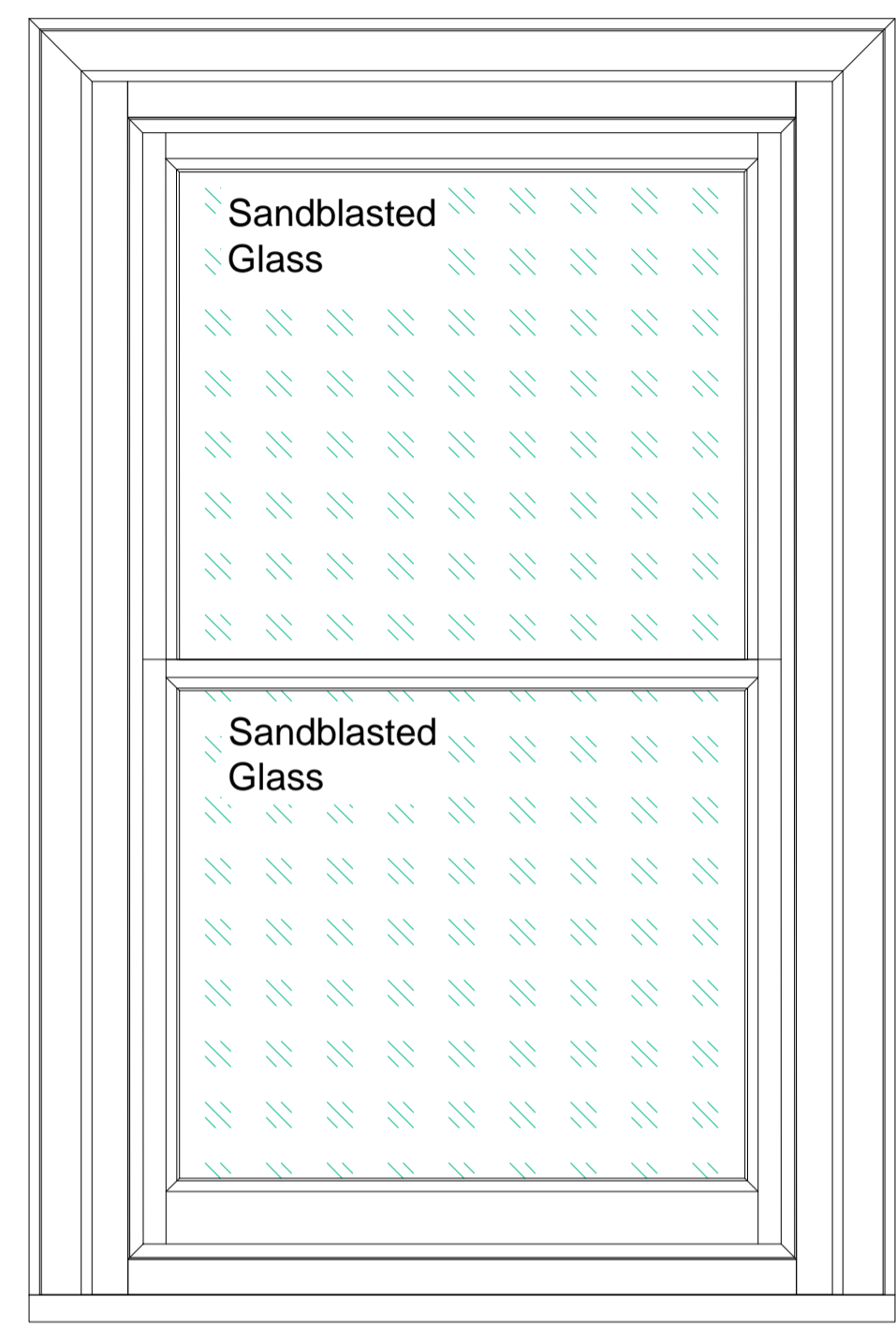
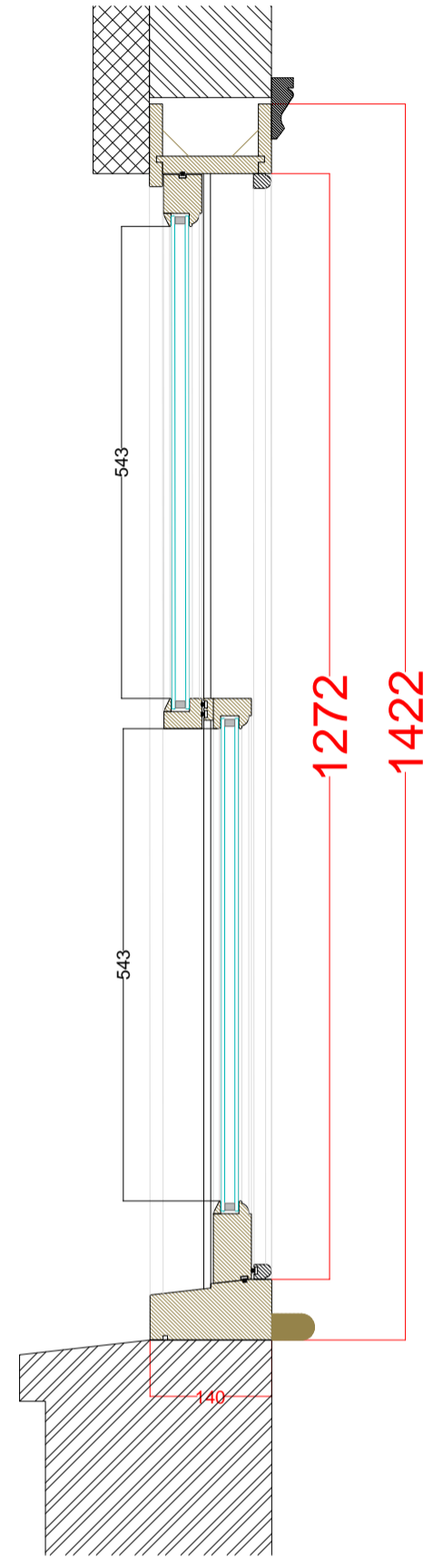
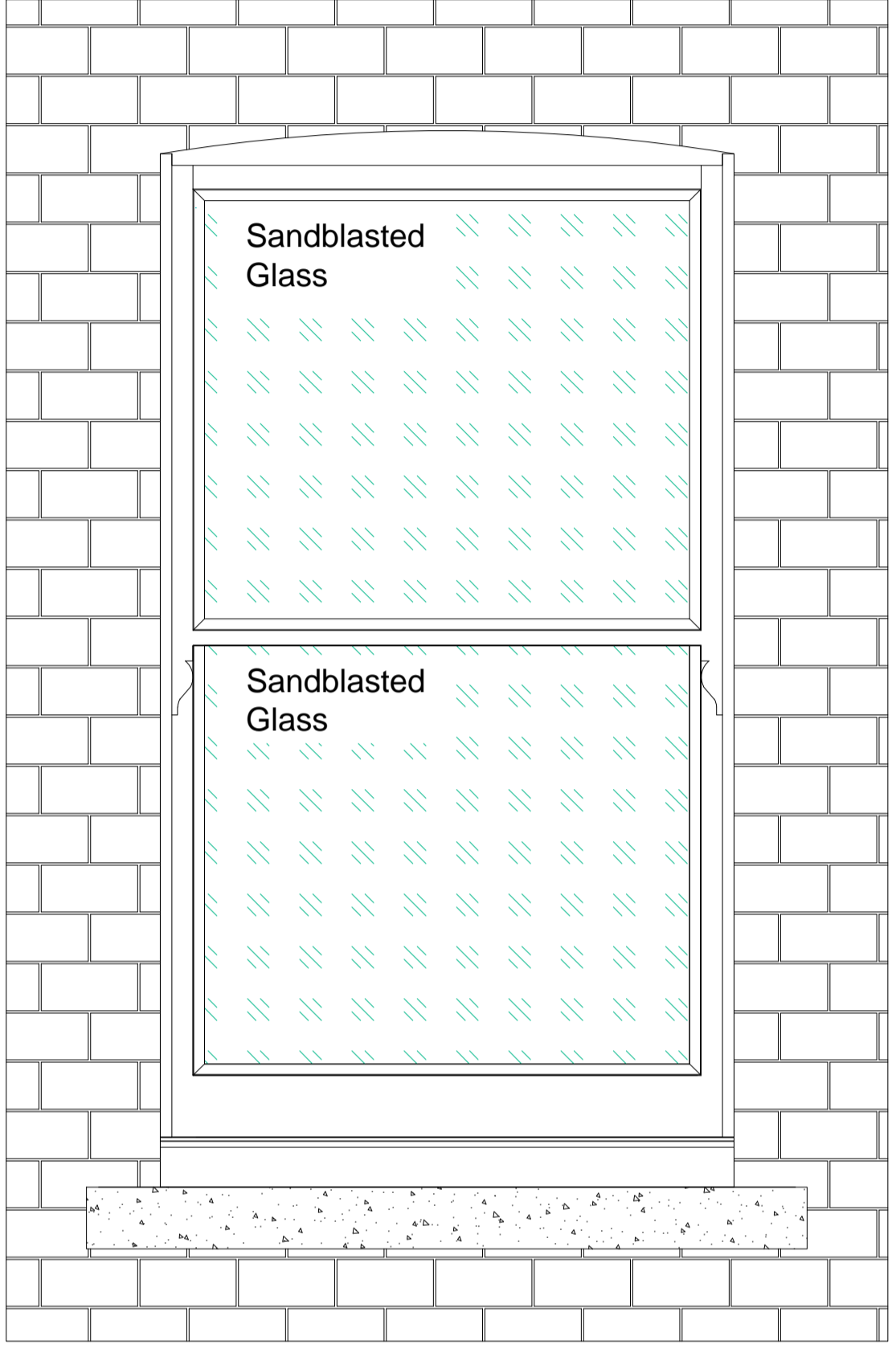

SPECIFICATION	
No OF WINDOWS	1 No, Full Box
WOOD	SOFTWOOD, HARDWOOD SILL
TYPE	LEAD WEIGHT
HORNS	YES Top Sash, MODEL No 2
DRAFT PROOF	YES
GLASS- TOP SASH	Sandblasted Glass , 4-12-4 mm ARGON FILLED SEALED UNIT, K GLASS
GLASS- BOTTOM SASH	Sandblasted Glass , 4-12-4 mm ARGON FILLED SEALED UNIT, K GLASS
ARCHITRAVES	YES
WINDOW BOARD	NONE
FINISH/PAINT	WHITE GLOSS OUTSIDE / TBC Inside
SPACER BAR COLOR	WHITE
IRONMONGERY	Brass
IRONMONGERY QTY.	2 No SASH PULLS+ 2 No SASH LIFTS
	1 No HOOK LOCKING
ADDITIONAL IRONMONGERY	Security Restrictors
COMMENTS	

Approval Sketches

	Full Box Replacement			
	Wandsworth Sash Windows	First Floor Bathroom Window W-01-05	Date:03.2016	Scale:
Full Box Replacement	ADDRESS:130 Ardgowan Rd	REVISION 1	Sheet:1-1	